

USER MANUAL

VORTEX INLINE FAN SYSTEMS

Model: TitianPro S6/TitianPro T6

WELCOME

Thank you for choosing ABESTORM. We are committed to product quality and friendly customer service. If you have any questions or suggestions, please don't hesitate to contact us. Visit www.abestorm.com and click contact for our contact information.

MANUAL INDEX

Key Features.....	1
Product Contents.....	3
Installation (Mounting).....	5
Installation (Configuration Setup).....	8
Powering and Setup.....	11
More Ways to Connect.....	14
Cleaning.....	15
Programming.....	16
FAQ.....	21
Warranty.....	23

KEY FEATURES

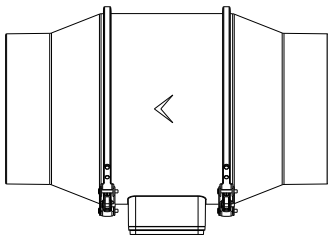

1. Features of DC brushless PWM-controlled motors. Precise speed control, reduced rotor noise, and energy-saving and efficient output.
2. The V-shaped hoop, is easy and fast disassembly, while having IP-44 sealing protection, and high resistance to liquids and dust.

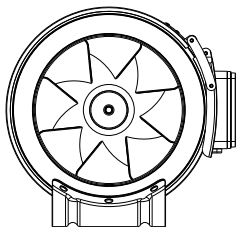

3. Supercharged turbine blades provide high static pressure output for more powerful wind.
4. Double ball bearings and standard with each factory product for dynamic balance test, so that the product runs more quiet life longer.

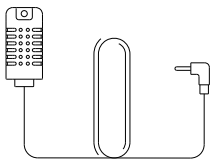
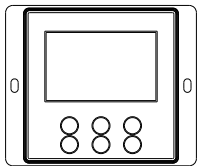

5. The TitianPro T-Series can be programmed to control as you wish, with warm and humid environments and time systems running in parallel to meet your unlimited needs. The controller has a memory function, and after a power failure, the turn-on power can resume the last facility for operation.

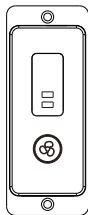

6. The TitianPro S-series is controlled by 1 key for 5 types of wind speed operation. The controller comes with a memory function, and after a power failure, the turn-on power can resume the last facility for operation.

PRODUCT CONTENTS

TitianPro S-Series



Manual Controller x1



Wood Screws x2

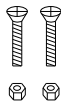

Mechanical
Screws/Nuts x2

TitianPro T-Series



Digital Controller x1



Temperature and
Humidity Sensors x1



Expansion Tube/
Fixing Screws x2



Wood Screws x3



Mechanical
Screws/Nuts x2

Fan Accessories

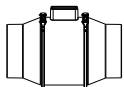

Fan Assembly x1



Pipeline hoops x2



Nylon Ties x2



Nylon Ties Seat x2



Adapter x1



Power Cord x1



Wood Screws x4



Machine Screws/Nuts x4



Expansion Tube/
Fixing Screws x4

PRODUCTS EXPLODED VIEW

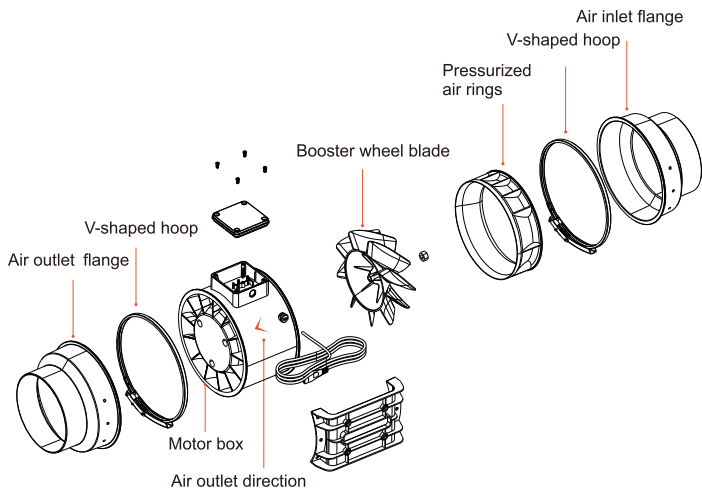

INSTALLATION

(MOUNTING)

STEP 1: Open the 2 V-shaped hoops and remove the fan body.

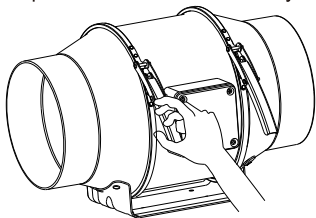

STEP 2: Remove the motor box from the flange bracket.

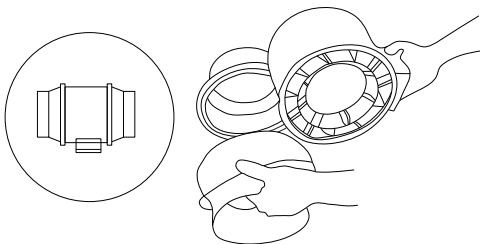

STEP 3: Use the flange bracket to locate where you want to mount the fan. Mark the four mounting holes.

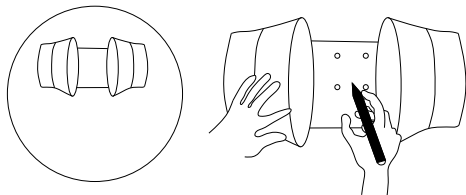

STEP 4: Drill four holes into the marked locations. Make sure your mounting area is structurally sound and free from obstruction.

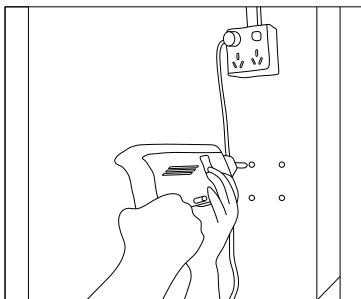

STEP 5: If you are installing on a concrete/brick wall, you will need to use expansion screws, expansion tubes, and fixing screws to insert into the wall mounting holes. You will need to use a hammer to make sure they are installed in place.

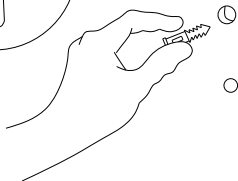
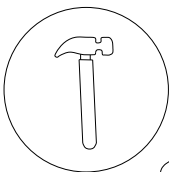
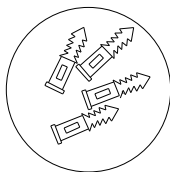

STEP 6: Align the fan mounting holes with the wall plate mounting location and secure the flange bracket to the mounting location with four screws or expansion screws. Make sure its airflow arrow is pointing in the direction you want it to go.

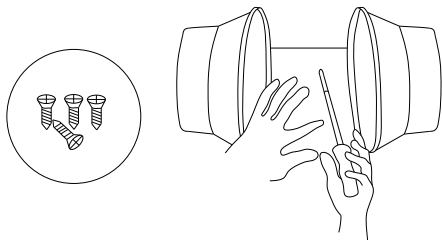

STEP 7: Reposition the 2 V-shaped hoops on the flange frame.

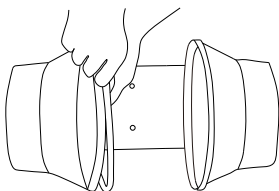

STEP 8: Install the motor box back into the flange bracket, and make sure that the airflow arrow points in the direction you want the air to flow out.

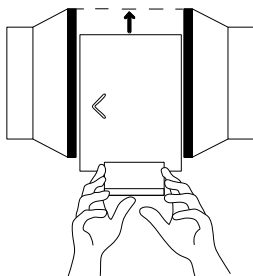

STEP 9: Reinstall the 2 V-shaped hooks back into the machine body so that they are connected intact.

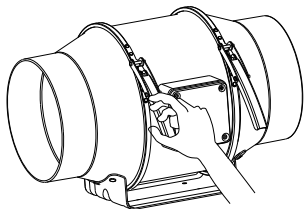

STEP 10: If ducting is installed, secure it to the ends of the duct fan using the included duct huggers to ensure a tight seal.

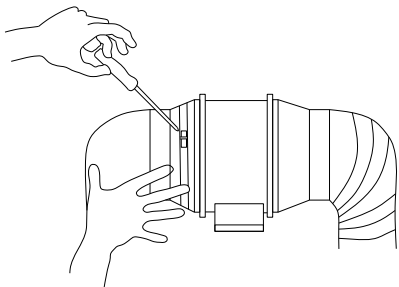

(CONFIGURATION SETUP)

STEP 11-A

If the installation requires a rope hanger (sold separately), wrap the rope around the flange and pull the rope tight to secure the fan body.

You can also hang the hanger from its mounting plate, hook the fan up, and secure the fan with the rope. Make sure the fan's airflow arrow is pointing in the direction you want it to go.

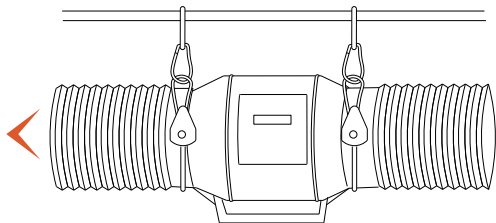
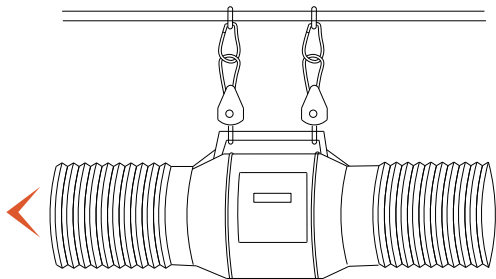

STEP 11-B

This fan can be used as either an intake fan or an exhaust fan in grow rooms and larger grow tents. For best ventilation, the intake fan must be installed in the bottom corner of the grow space. The exhaust fan must be suspended (as shown below) or mounted at the highest possible diagonal.

Make sure the airflow arrow of the intake fan is pointing into your grow space and the exhaust fan arrow is pointing out of your grow space.

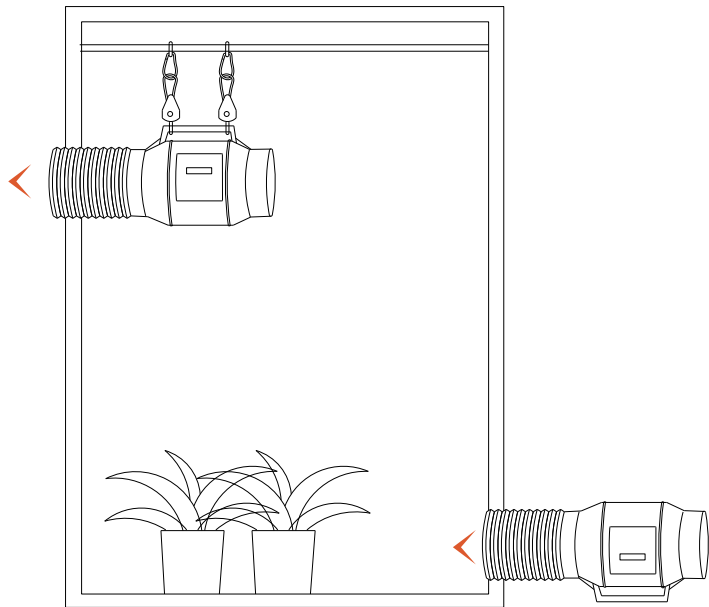

POWERING AND SETUP

S-SERIES

STEP1: Plug the 4-pin connector of the ventilation fan into the port on the top of the speed controller.

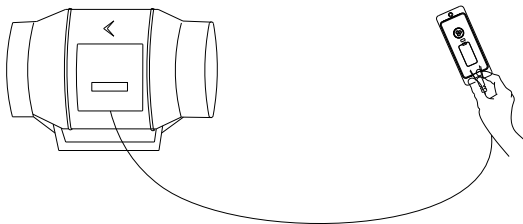

STEP2: Plug the adapter DC plug into the bottom port of the controller and finally plug the fan power cord into an AC power outlet.

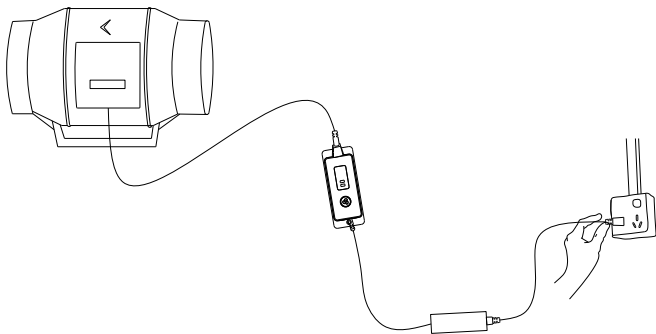

T-SERIES

STEP1: You can manage cables, temperature and humidity sensors and fans with nylon ties, tie holders, wood screws, and mechanical screws.

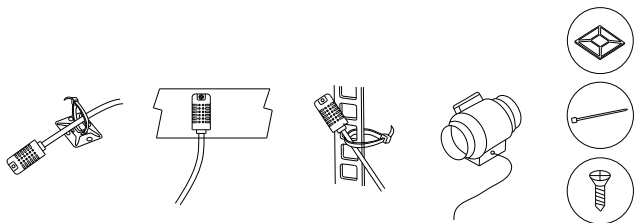

STEP2: Plug the 4P connector of the fan into the left port of the universal controller.

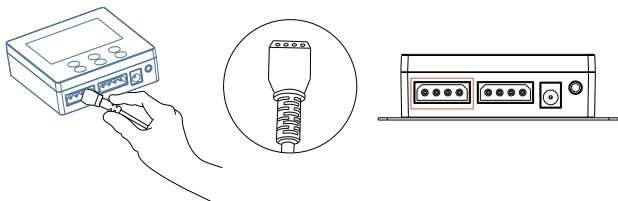

STEP3: Plug the sensor probe into the 3.5mm jack on the bottom of the controller and keep the probe close to the location you need to cool down or ventilate (grow tent, short building) for the most accurate readings.

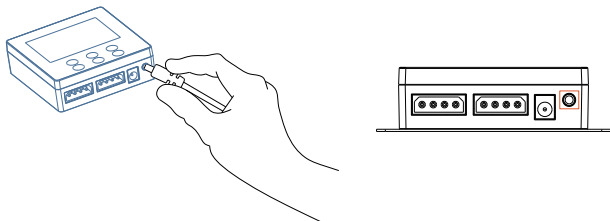

STEP4: Plug the adapter power cord into the controller as shown below, and finally to drive both the fan and the controller, plug the adapter power cord into an AC power outlet.

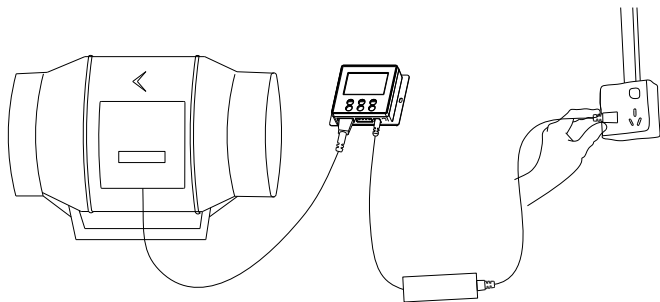
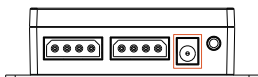
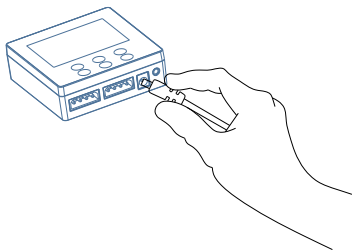

MORE WAYS TO CONNECT

The TitanPro T-Series digital controller has an additional port so you can add a TitanPro fan that can help you control 2 TitanPro fans at the same time.

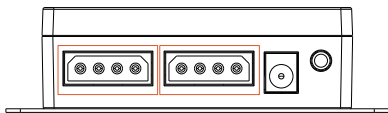

Dual Connection

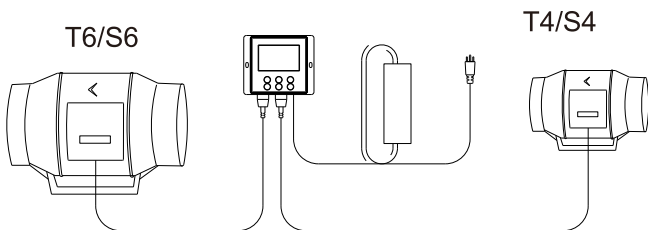

CLEANING

STEP1: Remove the motor box from the mounting flange. (Refer to steps 1 and 2 of the mounting installation section to learn how to remove the motor box).

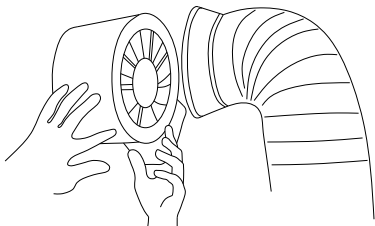

STEP2: Remove the pressurized air rings between the motor box and the air inlet flange. Remove dust and debris from the motor box, booster ring and fan blades with a damp cloth.



STEP3: Remove dust and debris from the stator blades and the output exhaust flange area at the other end to ensure complete cleanliness.

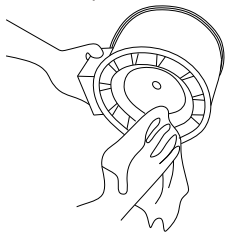

STEP4: Secure the motor box onto the mounting flanges. Refer to step 7-9 to learn how to install the TitianPro.

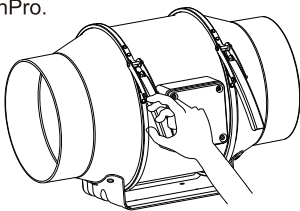

PROGRAMMING

S-SERIES

FAN SPEED ADJUSTING

The controller has only one button that controls the fan speed from the 0-5/off circulation. Press the button to increase the fan speed by one unit.

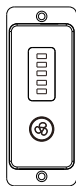

POWERING ON/OFF

When turning it off, press the wind speed button once to turn on the fan; When the wind speed is 5 gears, press it again to turn it off, or press and hold the button for 3 seconds at any gear to turn off the fan.



T SERIES OPERATING INSTRUCTIONS

1.Menu button

Adjusts options with each press of the menu key; used to set temperature, temperature units, and humidity for cyclic page transitions.

2.Up/Down button

Adjust the setting in the option you are in; The up button indicates an increase and the down button indicates a decrease, and the temperature unit option is used to switch units.

3.Time system button

Press the first time to start the time setting, the second time to start the cycle time, and the third time to turn off the time system.

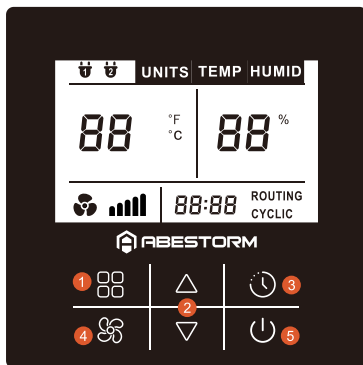

4.Wind speed button

Each press the air volume key to adjust the wind speed. 1-5 gears of the sequential cycle to switch.

5.On/Off button

Turns the device on/off with each press.

T-SERIES PROGRAM SETTINGS

Unit Setting

Menu key to enter UNITS option, press up/down key for °F/°C conversion of desired temperature unit.

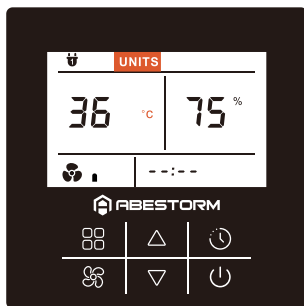
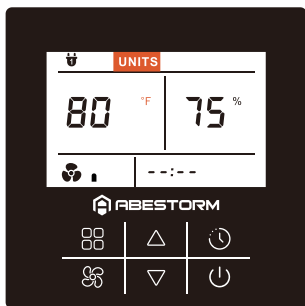

Temperature Control Program

Menu key to enter the TEMP option, press up/down to set the temperature you need to turn on/off, the ambient temperature is greater than the set value operation. Setting range: 37°F~176°F/1°C~80°C / "OFF", up or down 5°F/1°C per press of up/down key, long press for quick adjustment. Turn off this function when "OFF" is set. The product is shipped with a temperature setting of 86°F.

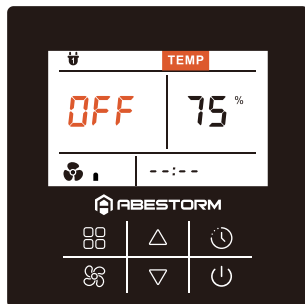
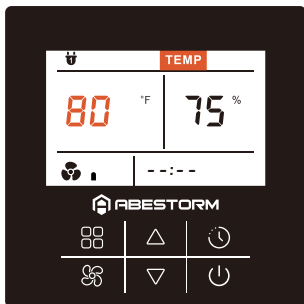

Humidity control program

Menu button to enter HUMID option, press up/down button to set the humidity level you need to turn on/off. Operation with ambient humidity greater than the set value. Setting range: 0~99% / "OFF", 1% up or down per press, fast adjustment on long press. Turn off this function when "OFF" is set. The product is shipped with a humidity setting of 50%.

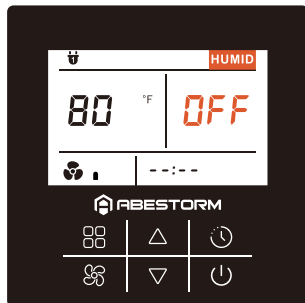
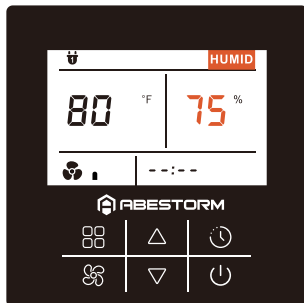

Time control program

Timer mode:

Press the time key to enter ROUTING option, then press the up/down key to set your desired running time; set and run automatically until the time is consumed and the machine stops.

Cycle mode:

Press time key to enter ROUTING option, press up/down key to set your desired running time; then press time key to enter CYCLIC option, press up/down key to set the machine rest time. After the setting is completed the machine will work on time for the stop and run cycle.

Note: "--:--" means the time control function is off.

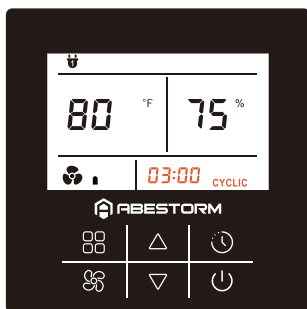
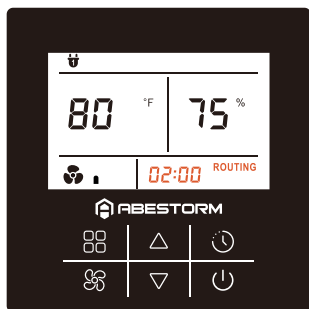

NOTE:

When both humidity control procedures are set at the same time, When temperature and humidity programs are set at the same time, the device can be started by satisfying either or both programs. Humidity control program and time control program can be edited at the same time, can reach to meet your required temperature and humidity conditions, according to the time set to run the cycle work, do not meet your required temperature and humidity conditions to stop running.

FQA

Q: My controller is missing. It's not in my package!

A: Please refer to the picture on page 6 about what your controller should look like. Your controller should be neatly inserted in the box according to this product manual.

Q: Where is the best location for the temperature and humidity sensor?

A: Place the sensor as close as possible to the hottest or most humid part of the Indoor.

Q: Do I need to remove the plastic cover on the temperature and humidity sensor?

A: Yes. No, the plastic housing serves as a protection for the use of the sensor, and we design the sensor inside the housing to accurately read the climate conditions.

Q: Can I mount this inline blower fan vertically?

A: Yes, CloudStorm can be installed in any orientation, including vertical.

Q: Can I hardwire this fan to my own controller or thermostat?

A: We do not recommend hardwiring or connecting the fan's power cord. Modifications may compromise electrical safety and will void the warranty on this product.

Q: Do I need to use a power converter if I am not in the US?

A: The voltage range of this product is 100-240V AC, within this voltage range you only need a foreign to American standard conversion socket to use.

Q: Does the controller keep its settings after the power is turned off?

A: Yes. If the power to the controller is cut off and then powered back on, your settings will remain the same.

Q: I am not getting enough airflow even with the fan speed set to 5, what can I do?

A: Duct bends and excessive lengths can reduce the CFM performance of your fan. To maintain airflow, you can straighten and shorten the length of the ducts to eliminate as many bends and duct over length air resistance as possible.

WARRANTY

Upon receipt of the goods, the customer must log in to www.abestorm.com to fill in the warranty registration form and submit it to ABESTORM. We will receive your purchase and installation information and save it.

If the warranty registration is not sent to us, the warranty period will begin from the date the goods leave the warehouse. Be sure to record the serial number and installation date. You will need this information to receive the RA number.

The product has a shelf life of two years. If warranty service is required, The customer must contact ABESTORM Technical Support by email: sales@abestorm.com or by calling the local technical service phone number (888)276-9833, available Monday to Friday (8:00 am to 5:00 pm PST) to obtain a return authorization (RA number).

When ABESTORM receives the equipment (whether in the maintenance center or in the warehouse), ABESTORM, it will carry out the initial inspection. If the warranty is determined to be invalid, the customer must then pay all related maintenance and transportation costs for unit maintenance.

The warranty plan does not cover abuse or misuse of the unit. This includes physical damage, product immersion, incorrect installation (such as incorrect voltage input), and misuse for any reason other than the intended purpose. ABESTORM shall not be responsible for any indirect loss or incidental damage of any nature caused by the product.

From the date of replacement, new equipment will be provided to the customer during the warranty period of the same year.

After parts are repaired or replaced by ABESTORM, the original warranty will continue to apply until the due date.



Abestorm Solutions INC.

Add: 8605 SANTA MONICA BLVD#79525 WEST HOLLYWOOD, California, 90069 USA

E-mail: sales@abestorm.com